

<b>Model</b>	ST10	<b>Volt/Hz</b>	<b>Date of Modification</b>	<b>Serial Number</b>
<b>Modified Article</b>	Bin Drive Motor, Main Board			
<b>Reason for Modification</b>	To meet the CE Mark standards.			

Old P/N	New P/N	Description	Q'ty Used	Inter-change-ability	Parts Catalog	
					Index No.	Page
AX06 0110	AX06 0122	Bin Drive Motor	1 → 1	X/O	6	9
A555 5100	A555 5105	Main Control Board	1 → 1	X/O	4	11

NOTE: In markets other than Europe, the interchangeability is O/O.

M. Iwasa, Manager  
 Technical Support Department

MODEL NAME	V/Hz	DESTINATION	CODE	REI PRODUCTION SERIAL NUMBER
ST 10	115/60	USA, Canada	A555-15	2A55070001
ST 10	115/60 220, 240/50	Whole World	A555-17	A3815070001
ST 10	115/60 220, 240/50	Whole World	A555-22	8825070001
ST 10	220, 240/50	Europe	A555-26	3G80750001

<b>Model</b>	ST10	<b>Volt/Hz</b>	<b>Date of Modification</b>	<b>Serial Number</b>
<b>Modified Article</b>	Parts Catalog	No serial number cut-in information.		
<b>Reason for Modification</b>	The number for the pin-3x32 is missing from the parts catalog. Please add the number below to your parts catalog.			

New P/N	Description	Q'ty Used	Parts Catalog	
			Index No.	Page
0633 0320G	Pin - 3 x 32	0 → 1	103	3

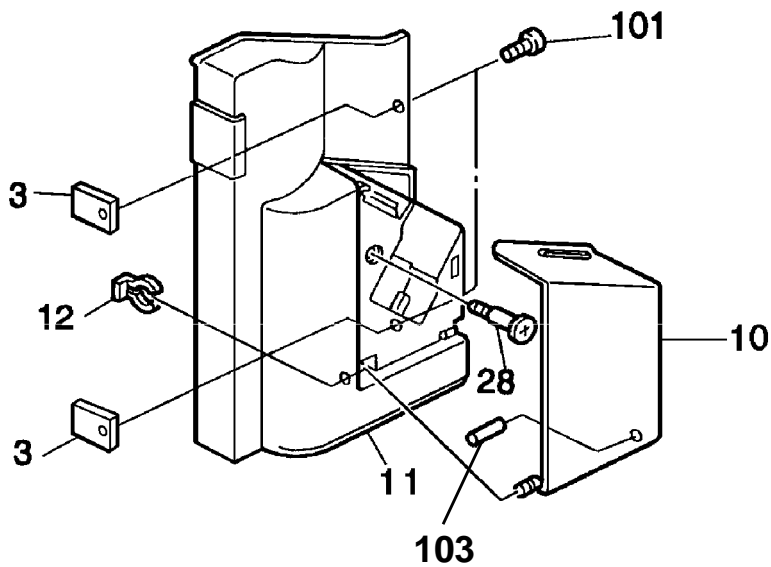

*T. Inoue*

T. Inoue, General Manager  
1st Field Information Dept. QAC

<b>Model</b>	ST10	<b>Volt/Hz</b>	<b>Date of Modification</b>	<b>Serial Number</b>
<b>Modified Article</b>	Bin, Bin Guide Roller			
<b>Reason for Modification</b>	The Bin Guide Roller and the bin have been changed to simplify the assembly.			

Old P/N	New P/N	Description	Q'ty Used	Inter-changeability	Parts Catalog	
					Index No.	Page
A555 3111	A555 3102	Bin	11 → 11	X/X	1	9
A555 3231	A377 3447	Bin Guide Roller	22 → 22	X/X	3	9

The interchangeability as a set is X/O.

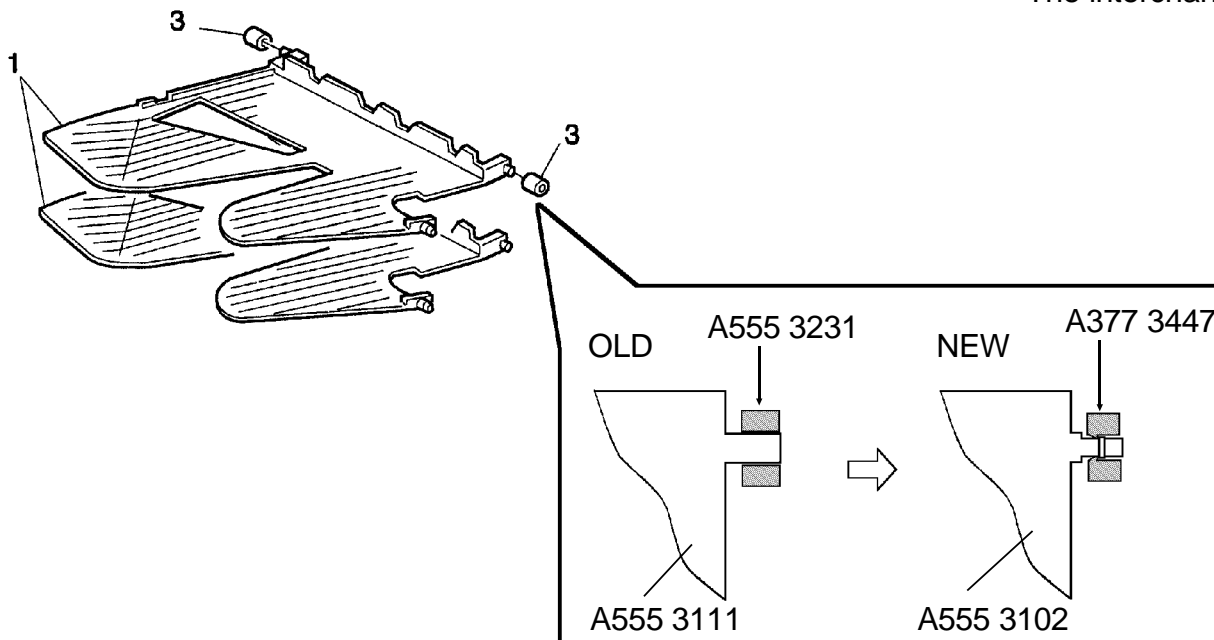

*T. Inoue*  
T. Inoue, General Manager  
QAC 1st Field Information Dept.

MODEL NAME	V/Hz	DESTINATION	CODE	JAPAN PRODUCTION SERIAL NUMBER
ST 10	115/60	USA, Canada	A555-15	2A56100001
ST 10	115/60 220, 240/50	Whole World	A555-17	A3816050237
ST 10	115/60 220, 240/50	Whole World	A555-22	8826060001
ST 10	220, 240/50	Europe	A555-26	3G80660001

Model: ST10		Date: 15-Apr-97	No: 4
Modified Article: Stapler		Prepared by: S.Hizen	
From: QAC 1st Field Information Dept.		Checked by: T. Inoue <i>T. Inoue</i>	
Reason for Modification:	<input type="checkbox"/> Parts catalog correction <input type="checkbox"/> Vendor change <input type="checkbox"/> To meet standards <input type="checkbox"/> To facilitate assembly <input type="checkbox"/> To improve reliability ( ) <input checked="" type="checkbox"/> Part standardization <input type="checkbox"/> Other		

Old part number	New part number	Description	Qty	Int	Page	Index	Note
AJ011008		Stapler EH - 150R					
	→ AJ01-1011	Stapler EH - 155R	1-1	O/O	5	4	

Model: ST10 (Phoenix Series)		Date: 31-Aug-97	No: 5
Modified Article: Stapler Actuator Switch		Prepared by: S.Hizen	
From: QAC 1st Field Information Dept.			
Reason for Modification:	<input type="checkbox"/> Parts catalog correction	<input type="checkbox"/> Vendor change	<input type="checkbox"/> To meet standards
	<input type="checkbox"/> To facilitate assembly	<input checked="" type="checkbox"/> To improve reliability	( )
	<input type="checkbox"/> Part standardization	<input type="checkbox"/> Other	

Old part number	New part number	Description	Qty	Int	Page	Index	Note
A5553182	A5553187	Stapler Actuator Switch	1- 1	X/O	7	10	
	A5553186	Mylar – 63x4.5			7	32	

The Mylar #A555-3186 has been added to the Actuator Switch to prevent noise.

The part #A5553187 is for the assembled part (Stapler Actuator Switch with the mylar).

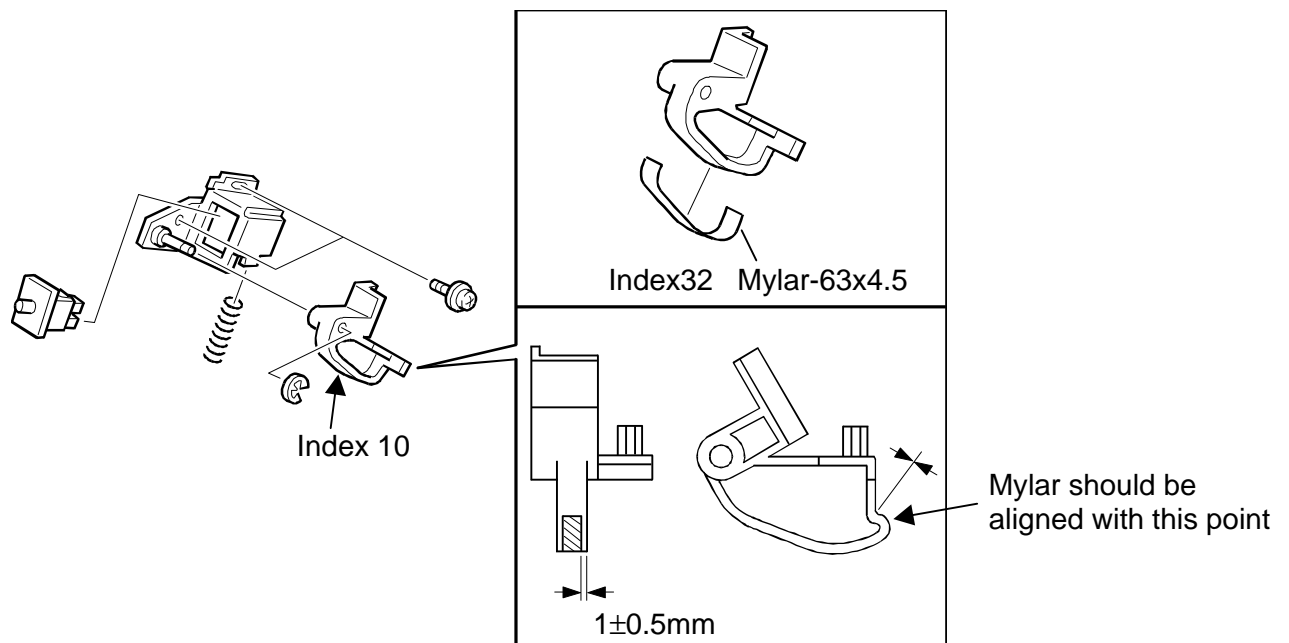

Model: ST10 (Phoenix Series)	Date: 31-Aug-97	No: 5
------------------------------	-----------------	-------

MODEL NAME	V/ Hz	DESTINATION	CODE	SERIAL NUMBER
ST 10	115/ 60	USA, Canada	A555- 15	2A55070001
ST 10	220, 240/ 50 115/ 60	Whole World	A555- 17	A3815070001
ST 10	220, 240/ 50 115/ 60	Whole World	A555- 22	8825070001
ST 10	220, 240/ 50	Europe	A555- 26	3G80750001



Model: Phoenix-10bin -S/S		Date: 21-Nov-01	No.: MA555006
Modified Article: Anti Static Brush		Prepared by: M. Kitajima	
From: Technical Services Dept., GTS Division			
Reason for Modification:	<input type="checkbox"/> Parts catalog correction <input type="checkbox"/> To facilitate assembly <input type="checkbox"/> Part standardization	<input type="checkbox"/> Vendor change <input checked="" type="checkbox"/> To improve reliability <input type="checkbox"/> Other	<input type="checkbox"/> To meet standards (      )

To prevent the brush from coming out, the material of the plate for the antistatic brush has been changed from carbon to SUS.

Old part number	New part number	Description	Q'ty	Int	Page	Index	Note
A5552161	A5552166	Anti Static Brush	1	X/O	3	22	

### RCL (Japan) Production

MODEL NAME	V/ Hz	DESTINATION	CODE	SERIAL NUMBER
ST 10	115/ 60	USA, Canada	A555- 15	2A51050001
ST 10	220, 240/ 50 115/ 60	Whole World	A555- 17	A3811050001
ST 10	220, 240/ 50 115/ 60	Whole World	A555- 22	8821050001
ST 10	220, 240/ 50	Europe	A555- 26	3G80510001

Model: Phoenix-10bin -S/S		Date: 30-Jan-02	No.: MA555007
Modified Article: Bin Drive Motor		Prepared by: M.Kitajima	
From: Technical Services Dept., GTS Division			
Reason for Modification:	<input type="checkbox"/> Parts catalog correction	<input type="checkbox"/> Vendor change	<input type="checkbox"/> To meet standards ( )
	<input type="checkbox"/> To facilitate assembly	<input type="checkbox"/> To improve reliability	
	<input type="checkbox"/> Part standardization	<input checked="" type="checkbox"/> Other	

The following parts have been changed, as the old Bin Drive motor has been discontinued from production.

**Note:** The interchangeability is X/X for each individual part, but O/O as a set.

Old part number	New part number	Description	Q'ty	Int	Page	Index	Note
AX060122	AX060219	Bin Drive Motor	1 - 1	X/X	9	6	O/O as a set
A3763532	A5553172	Timing Pulley 18Z	1 - 1	X/X	9	8	
A5553171	A5553173	Drive Motor Bracket	1 - 1	X/X	9	25	
	03130050B	Philips Pan Head Screw - M3x5	n - (n+1)	-	9	105	

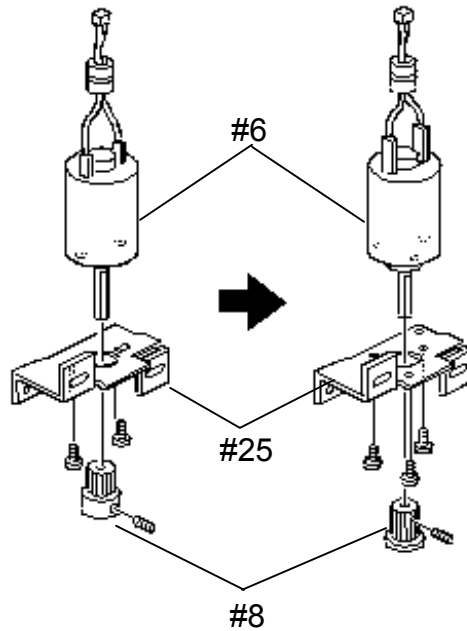

### RCL (Japan) Production

MODEL NAME	V/ Hz	DESTINATION	CODE	SERIAL NUMBER
ST 10	115/ 60	USA, Canada	A555- 15	2A51020001
ST 10	220, 240/ 50 115/ 60	Whole World	A555- 17	A3811020001
ST 10	220, 240/ 50 115/ 60	Whole World	A555- 22	8821020001
ST 10	220, 240/ 50	Europe	A555- 26	3G80210001